



# 4600 Data Sheet

SERIES: 4000 WOOD TILES

STYLE: 4600 TRUE ACCESS TILE



## Overview

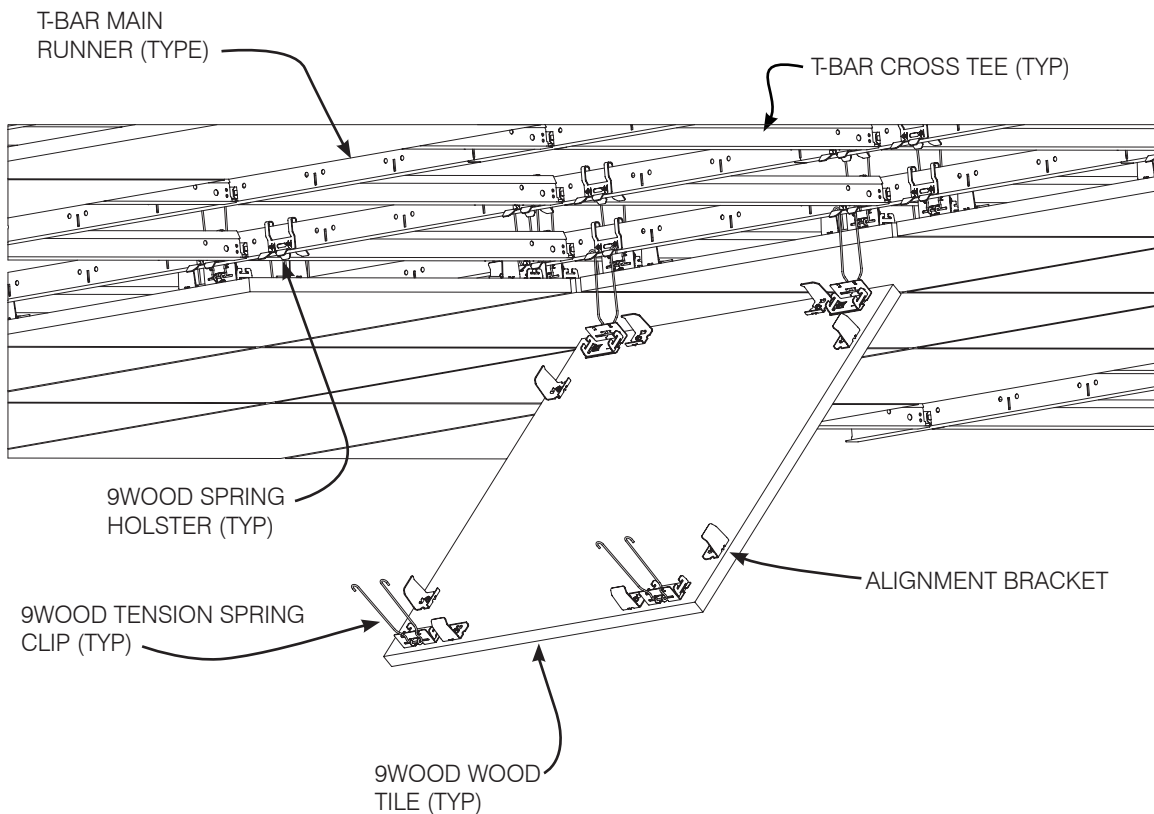

The **4600 True Access Tile** wood ceiling offers a floating tiled appearance with downward access. The 4600 style snaps up into notched T-Bar brackets. Reveals, 1/4" or 3/8" typically, conceal suspension grid.

**Attachment** for the True Access Tile is via 9Wood's Tension Spring Clip and Spring Holster Clip.



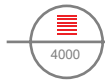

## 4600 Data Sheet

**SERIES:** 4000 WOOD TILES

**STYLE:** 4600 TRUE ACCESS TILE



# Product Data

## Application

The True Access Tile provides a floating tiled look with concealed suspension using real wood veneers on fire rated cores. This is an accessible system, with pull down, spring release accessibility. It can be engineered for seismic compliance. Tiles may be perforated (see series 5000 Perforated Wood Tiles).

## Performance

### Species & Finishes

Domestic and imported species are offered; clear, satin sheen finish is typical; custom stain matches available. Typical species include: Hemlock, Douglas Fir, Oak, Beech, White Maple, and Cherry.

### Fire Rating

Individual members and components can be treated with Class I (A) Fire Retardant chemicals (solid wood use FR coatings, veneered particleboard use FR formulas). Particular species or styles have not been tested.

### Acoustics

The 4600 style is considered acoustically reflective.

### System Weight

The 4600 True Access Tile weighs 3 lbs / sq ft.

### MEP

The 4600 tile permits MEP penetrations in the ceiling's surface. Cut panels may require supplemental reinforcement. Fixtures and diffusers must be independently supported.

### Suspension

Wood Tiles are suspended using 15/16" heavy duty T-bar main runners.

### Seismic

True Access Tiles can be engineered to meet seismic requirements. Consult local code for any additional requirements or a licensed local engineer.

### LEED

9Wood products may qualify toward MR-3, MR-4.1/4.2, MR-5.1/5.2, MR-6, MR-7, IEQ-4.2, IEQ-4.4. As all products are custom-fabricated, LEED credit opportunities are project by project. Please contact 9Wood, Inc. for specifics.

### Acclimatization

Wood Tile products must be cared for in a controlled interior environment (RH 25%-50% max; temp. 50°-85°) and installed only after reaching equilibrium moisture content. Should the building fall outside these limits consult 9Wood, Inc. for our 3 Tests/3 Tracks Acclimatization Advisory.



# 4600 Data Sheet



SERIES: 4000 WOOD TILES

STYLE: 4600 TRUE ACCESS TILE

## Typical Specifications

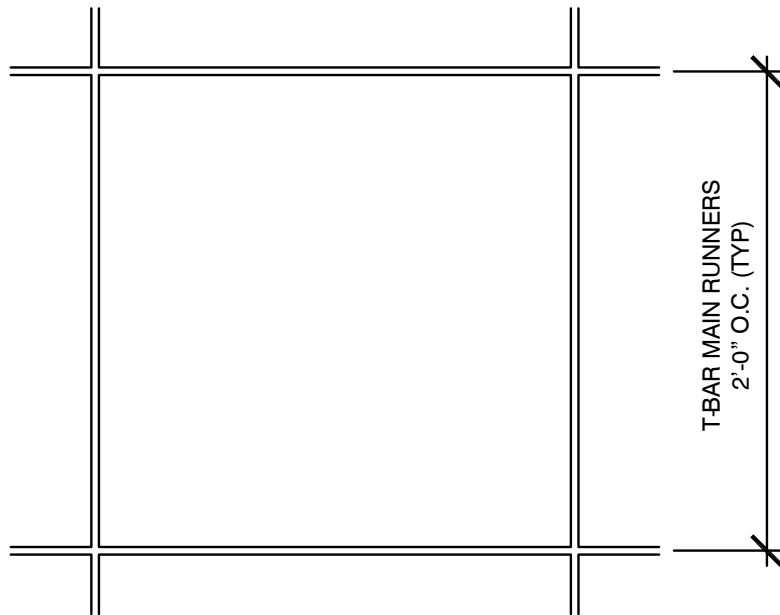

## SKU Table

Tile Width	Tile Length (Parallel to Grain Direction)						
	24"	36"	48"	60"	72"	84"	96"
24"	4624-24	4624-36	4624-36	4624-60	4624-72	4624-84	4624-96
36"	4636-24	4636-36	4624-36	4636-60	4636-72	4624-84	4636-96
48"	4648-24	4648-36	4648-48	4648-60	4648-72	4648-84	4648-96



# 4600 Data Sheet



SERIES: 4000 WOOD TILES

STYLE: 4600 TRUE ACCESS TILE

## Perimeter Conditions and Suspension

