



2300 Data Sheet



SERIES: 2000 LINEAR WOOD

STYLE: 2300 CONTINUOUS LINEAR

Overview

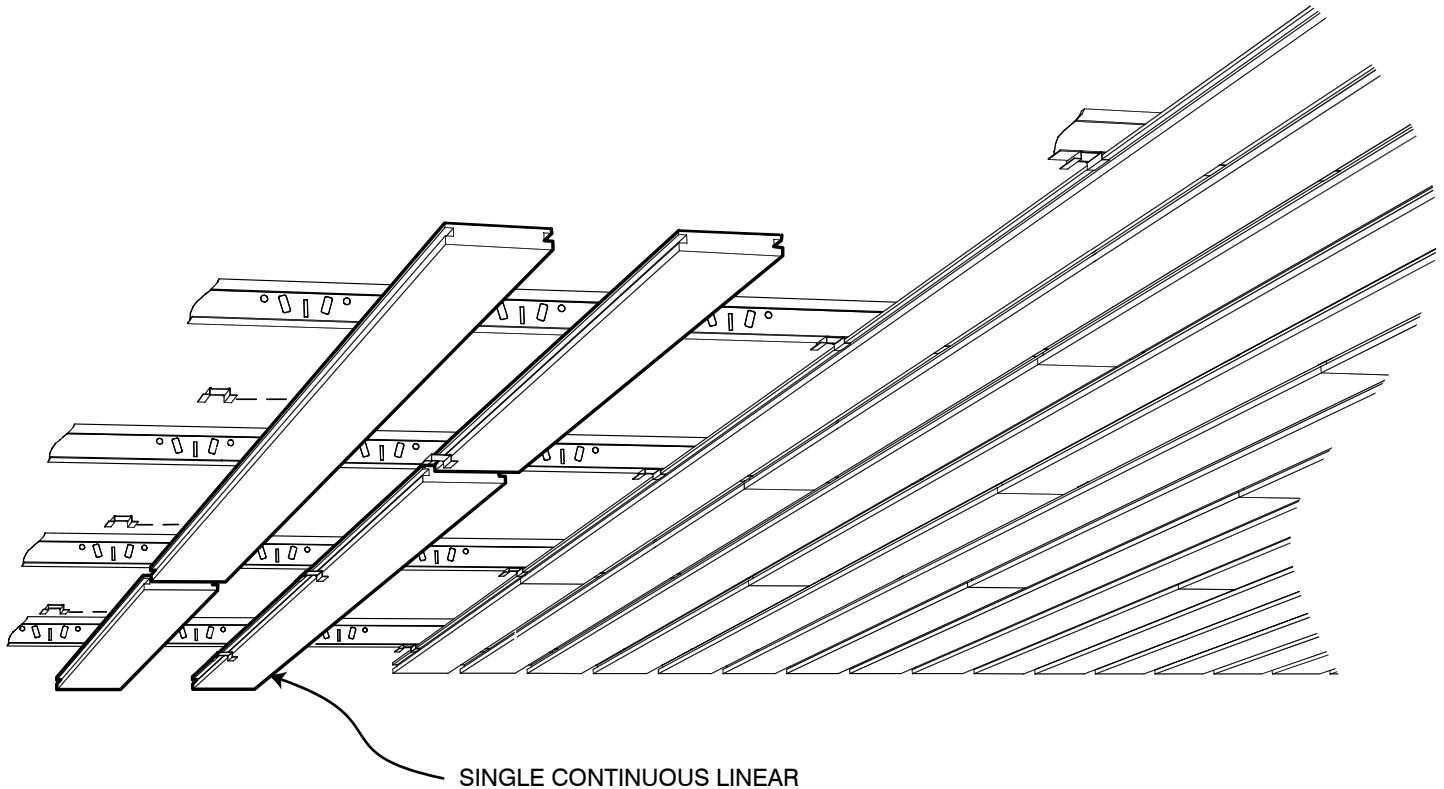

The **9Wood Continuous Linear** wood ceiling offers an open reveal linear design where the individual wood member is wider than it is deep. The lay-out is built around a 12" module. Members are installed randomly to create a continuous, random joint appearance. Lengths are random for solid wood, or 8' for veneers. Budget and application typically drive the decision between solid wood or veneers.

Attachment for the Continuous Linear is via progressive install, utilizing the 9Wood Speed Lock™ clip.



2300 Data Sheet



SERIES: 2000 LINEAR WOOD

STYLE: 2300 CONTINUOUS LINEAR

Product Data

Application

The Continuous Linear provides the classic open-reveal continuous linear appearance, creating a monolithic ceiling field. Access can be achieved through strategically located access panels or from ceiling perimeters. Members are clipped to T-Bar main runners progressively.

Performance

Acclimatization

Continuous Linears must be cared for in a controlled interior environment (RH 25%-55% max; temp. 60°-80°) and installed only after reaching equilibrium moisture content. Should the building fall outside these limits consult 9Wood, Inc. for our 3 Tests/3 Tracks Acclimatization Advisory.

Acoustics

The Continuous Linear can enhance acoustics via sound absorbing material placed over open reveals within the T-Bar grid. Insulation is typically provided locally.

Fire Rating

Individual members and components can be treated with Class I (A) Fire Retardant chemicals (solid wood use FR coatings, veneered particleboard use FR formulas). Particular species or styles have not been tested.

LEED

Continuous Linears may qualify toward MR-3, MR-4.1/4.2, MR-5.1/5.2, MR-6, MR-7, IEQ-4.2 or IEQ-4.4. As all products are custom-fabricated, LEED credit opportunities are project by project. Please contact 9Wood, Inc. for specifics.

MEP

The Continuous Linear permits MEP penetrations in the ceiling's surface. Supplemental suspension may be required at penetrations. Fixtures and diffusers must be independently supported.

Seismic

Continuous Linear Styles provide seismic code compliance by means of clips with mechanical direct screw attachment to T-Bar grid. Consult local code for any additional requirements or a licensed engineer.

Species & Finishes

9Wood can offer both domestic and imported species for the Continuous Linear. Clear, matte sheen finish is standard; custom color matches and opaque finishes are available.

Suspension

Continuous Linears are directly attached to 15/16" heavy duty T-Bar main runners. Main runners are installed 2' on center, depending on system weight.

System Weight

Continuous Linears typically weigh 2-4 pounds per square foot, depending on members per linear foot and species.



2300 Data Sheet



SERIES: 2000 LINEAR WOOD

STYLE: 2300 CONTINUOUS LINEAR

Typical Specifications

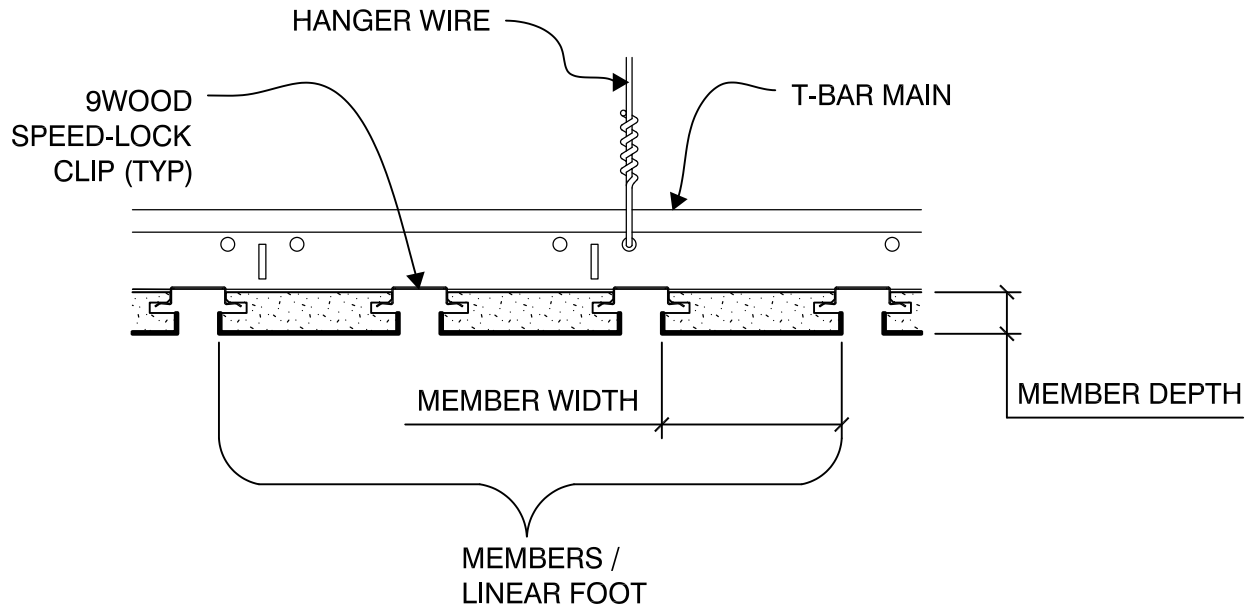

SKU Table

Depth (Softwood)	Depth (Hardwood or Veneer)	Width	Members per Linear Foot				
			2	3	4	5	6
5/8"	3/4"	2 1/4"	2313-4				
5/8"	3/4"	3 1/4"	2314-3				
3/4"	3/4"	5 1/4"	2316-2				

Additional width, depth, and M/LF options may be available. Please check with 9Wood if you don't see the combination that you have in mind.



2300 Data Sheet



SERIES: 2000 LINEAR WOOD

STYLE: 2300 CONTINUOUS LINEAR

Perimeter Conditions and Suspension

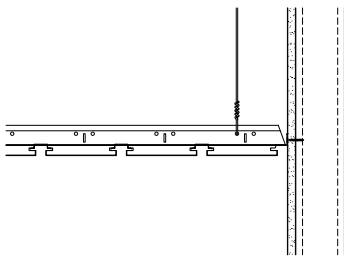
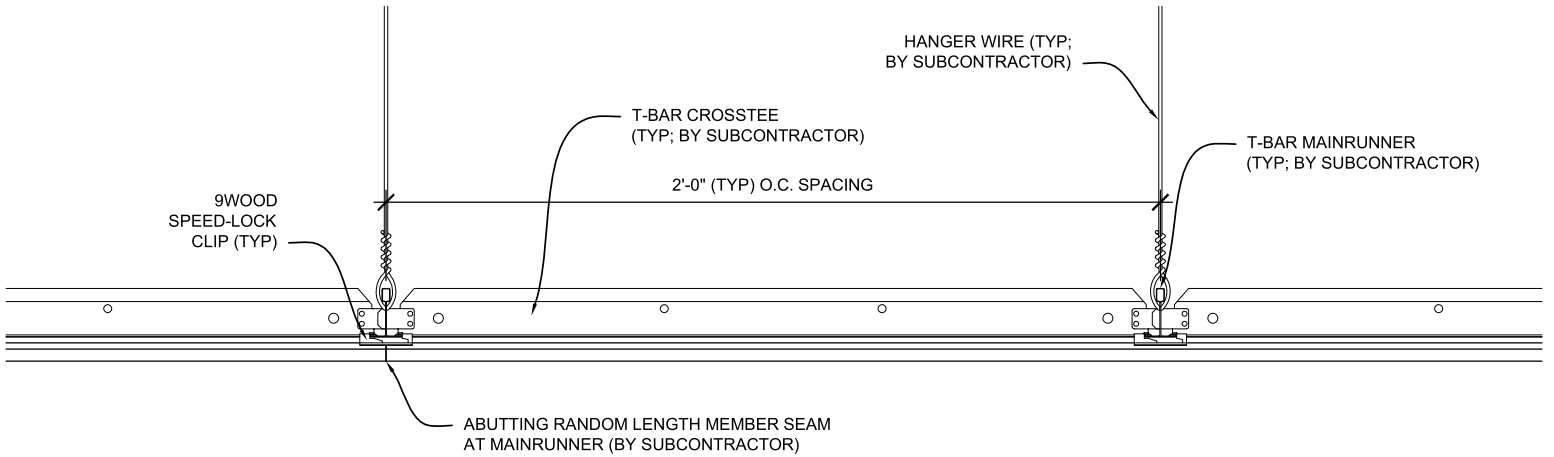

FLOATING OPEN REVEAL

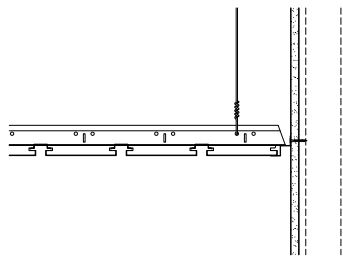

METAL TRIM
SHADOW STYLE WALL ANGLE

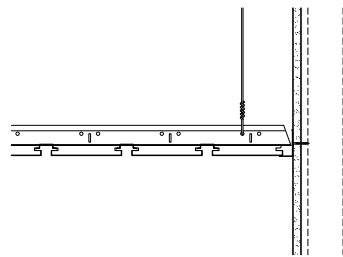

METAL TRIM WALL ANGLE

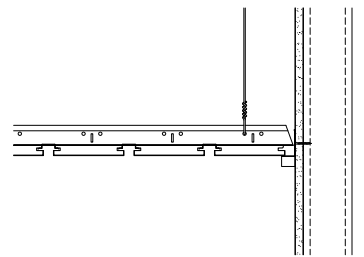

WALL ANGLE w/ WOOD TRIM